

BladeRep LEP 10

Technical Data Sheet:
442-9A/ BR1075

1. Introduction

ALEXIT BladeRep LEP10 is a specifically designed one-layer coating with excellent abrasion and erosion resistance. This two-component, solvent free polyurethane product has superior elasticity and flexibility for long-term leading edge protection.

2. Range of application

ALEXIT® BladeRep LEP 10 is used for extra protection on highly stressed areas like leading edges of wind turbine rotor blades.

3. Color

Similar to 7035 light grey. This product dries to a glossy finish.

4. Coverage

	m ² / cartridge	Square feet / cartridge
Theoretical coverage at 600 µm / 24 mil of mixed material approx.	0,7	7

Recommended dry film thickness: minimum 600 µm (24 mil)

5. Substrate pre-treatment

Sand the surface with 120 grit paper prior to applying BladeRep LEP 10. The surface must be clean, dry and free from dust, grease, oil and other contaminants. BladeRep LEP 10 may be applied over all BladeRep products and/or any properly prepared surface.

6. Trade names/part no.

Cartridge BR1075 ALEXIT® BladeRep LEP 10

7. Mixing

Mix by volume: Must be processed through a static mixer.

8. Equipment needed

- Cartridge
- Flex hose brush incl. static mixer
- Finish brush
- Sulzer Mixpac DP 400-85-01 2C-dispenser (or equivalent) with 1:1 mixing ratio

8. Preparation

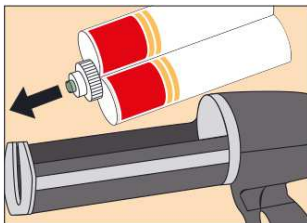

Put cartridge into pneumatic dispenser.

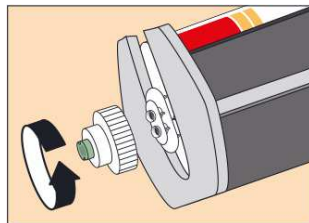

Remove cap from cartridge.



Press trigger until A and B components flow evenly.

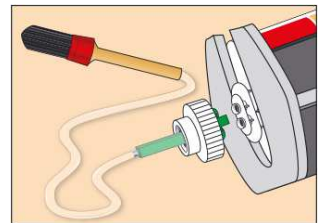

Mount mixer with flex hose brush onto the cartridge and apply material.

For Professional Use Only

Page 1 of 2

The information contained in this data sheet is based on our level of research and development. Revisal by the user with regard to the intended aim is necessary due to the diverse processing and application possibilities.

www.bladerep.com

Revision February 2018

BladeRep LEP 10

Technical Data Sheet:
442-9A/ BR1075

9. Application

Apply by Flex hose brush and Finish brush.

Application conditions:

15-32 °C (60-95 °F) and 20-70 % relative humidity.
The minimum application condition should be 3°C
(5.4°F) above dew point.

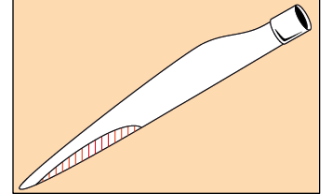

Application process for
brushing:

Apply 1 layer of ALEXIT® BladeRep LEP 10 to a wet film
thickness of minimum 600 µm (24 mil) by using
the Flex hose brush for applying the material, followed
by the Finish brush for proper smoothing and levelling.

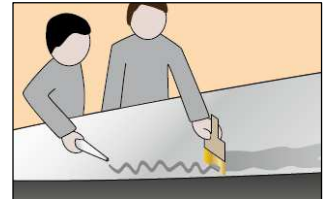

10. Pot life

5 - 10 min at 23 °C (73 °F)

11. Drying time

	15 °C (60 °F)	23 °C (73 °F)	30 °C (86 °F)
approx. 50% relative humidity	4 h	3 h	2 h

12. Packaging

Set A: 12x 400 ml cartridges

Set B: 12x 400 ml cartridges + 12x Flex hose brushes

Set C: 12x 400 ml cartridges + 12x Flex hose brushes + 12x Finish brushes

Please note: full set supplies only.

13. Storage

Store in original, unopened containers at a temperature of 5° - 35 °C (41 - 95 °F)
(in acc. with DIN EN 3840:2007).

For Professional Use Only

Page 2 of 2

The information contained in this data sheet is based on our level of research and development. Revisal by the user with regard to the intended aim is necessary due to the diverse processing and application possibilities.

www.bladerep.com

Revision February 2018